

082450M BMW R1300GS Spray Guard Extension 2023> Fitting Instructions

Kit Includes:

1.	X1	082450A	Spray Guard Extension (Lower)
2.	X1	082450B	Spray Guard Extension (Upper)
3.	X2	CBOLM50005	M5 x 12mm Button-Head Bolt
4.	X2	CNUTM50002	M5 Nyloc Nut
5.	X4	CWASM50002	M5 Flat Steel Washer
6.	X1	CTAP0052	Adhesive Sticker Sheet
7.	X1	CWIP001	Adhesion Promoter Wipe

OEM Parts (From the Motorcycle):

8.	X4	OEM R1300GS	M5 x 16mm Screw
----	----	-------------	-----------------

Assembly Instructions

- Begin by removing the 3 x torx-head bolts which hold the spray guard arm to the swingarm of the R1300GS. Once this has been done, proceed to remove the inner plastic piece which will now no longer be needed. Please remember to retain the 4 x screws (Item 8) that were holding this piece in position as they will be needed later!
- Please ensure the inside of your guard is clean in order to provide the best possible fitment. This can be done by using soapy water only, as the provided adhesion promoter wipe (Item 7) will not work effectively if other adhesive solvents have been used. Do not use the adhesion wipe until you are ready to fit the part.
- Assemble both the spray guard extension pieces (Items 1 & 2) using 2 x M5 bolts (Item 3), 4 x M5 washers (Item 5) and 2 x M5 nyloc nuts (Item 4), only tightening them slightly. See 'FIG. 1' for reference. Offer up the assembled piece to the spray guard, ensuring both fitment and hole alignment are correct. Proceed to tighten the part until sufficient resistance is felt. **Please do not overtighten the fixings.**
- Using the provided sheet of adhesive stickers (Item 6), place an assortment of stickers in the areas marked in 'FIG. 2' and 'FIG. 3'. Please use appropriately sized stickers for the area in which they are being applied and avoid covering the edges. Please note that not all the stickers provided will need to be used.
- Apply the adhesion promoter wipe to the inside of the guard. **Please ensure you keep the wipe well away from the external faces of the R1300GS spray guard and the Pyramid extension piece. The solution on the adhesion promoter wipe can react with the surface of any plastic it comes into contact with, resulting in staining to the plastic.**
- Remove the plastic layer from the stickers and gently lower the part into the spray guard. Do not press the part down. Align the part with the holes in the spray guard and using the OEM M5 fixings, attach the Pyramid Spray Guard Extension. Please do not fully tighten at this point to allow you to position the guard correctly. Manipulate the guard to sit correctly and proceed to fully tighten. Press down firmly in the areas where the stickers have been applied in order to promote adhesion. We recommend that you clamp these areas for a period of **12 hours**.
- Reattach the spray guard to the R1300GS. Installation of the Pyramid Spray Guard Extension is now complete.

Any questions?
sales@pyramidmoto.co.uk
+44 (0)1427 677990
www.pyramidmoto.co.uk

Please Note: We advise that all fixings are checked periodically.



Follow us on social media and
feel free to leave us a review!

082450M BMW R1300GS Spray Guard Extension 2023> Fitting Instructions

FIG. 2

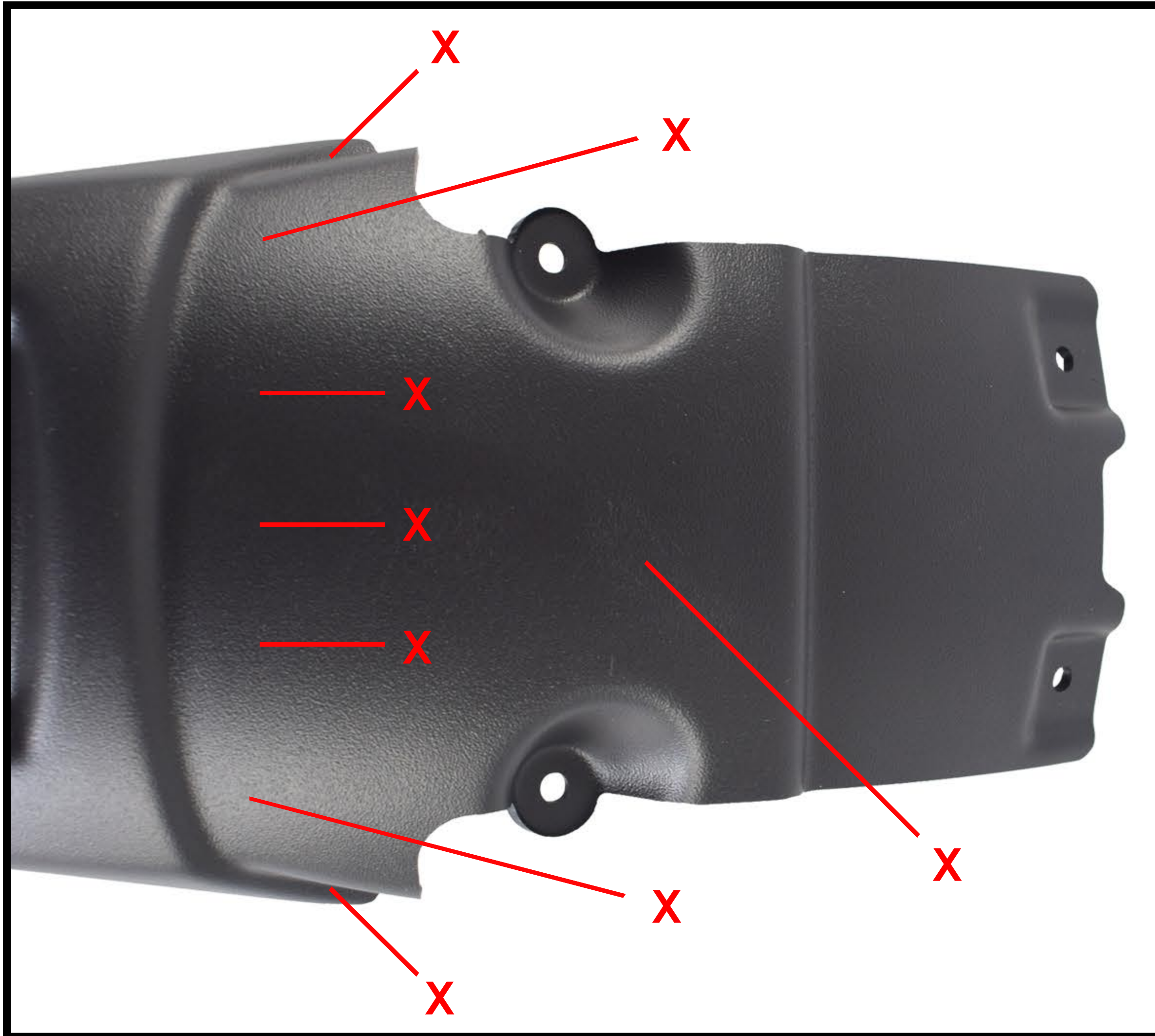

Please keep all stickers away from the edges and leave adequate spacing between them. Use more / less stickers at your own discretion.

FIG. 1

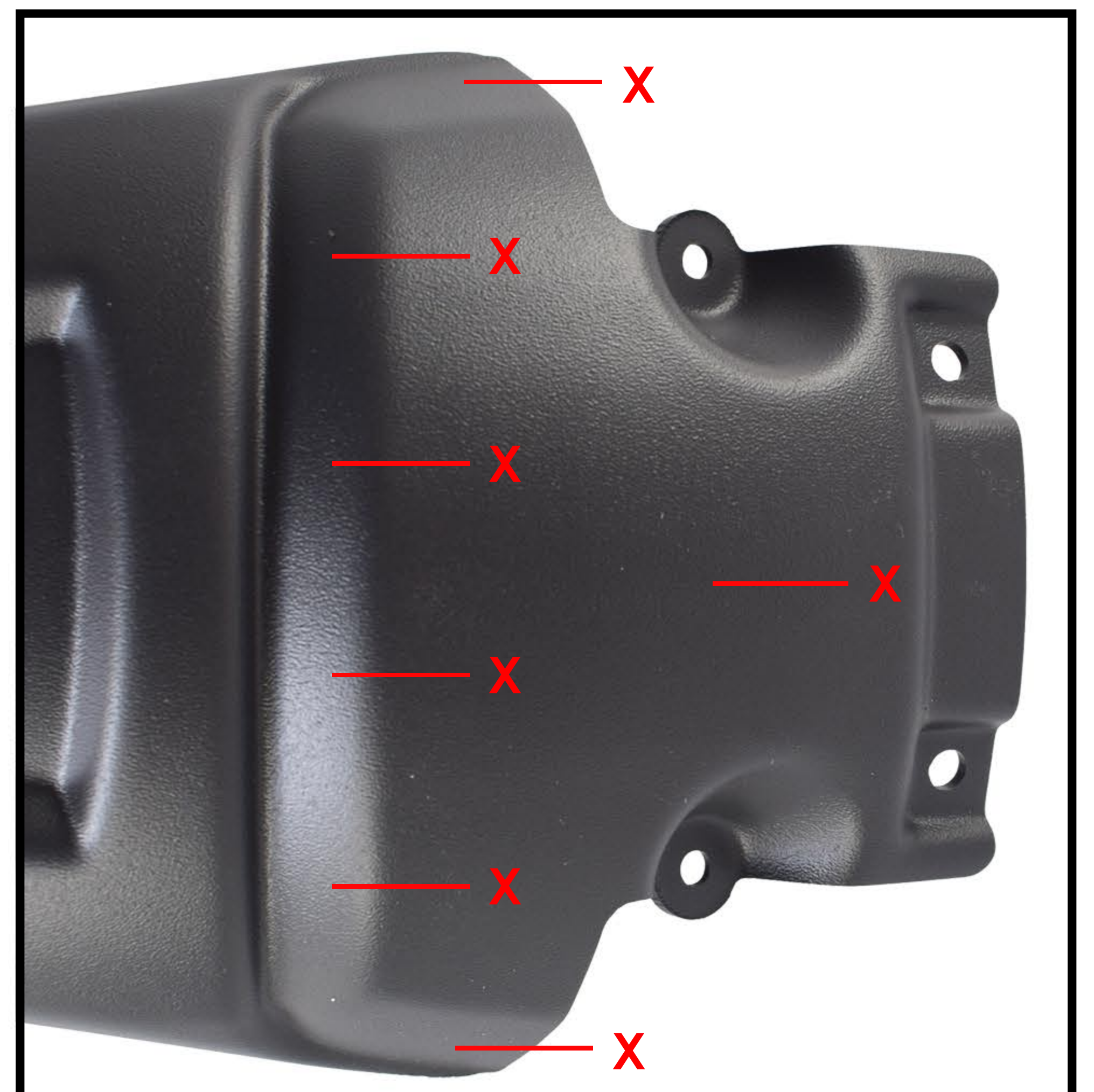
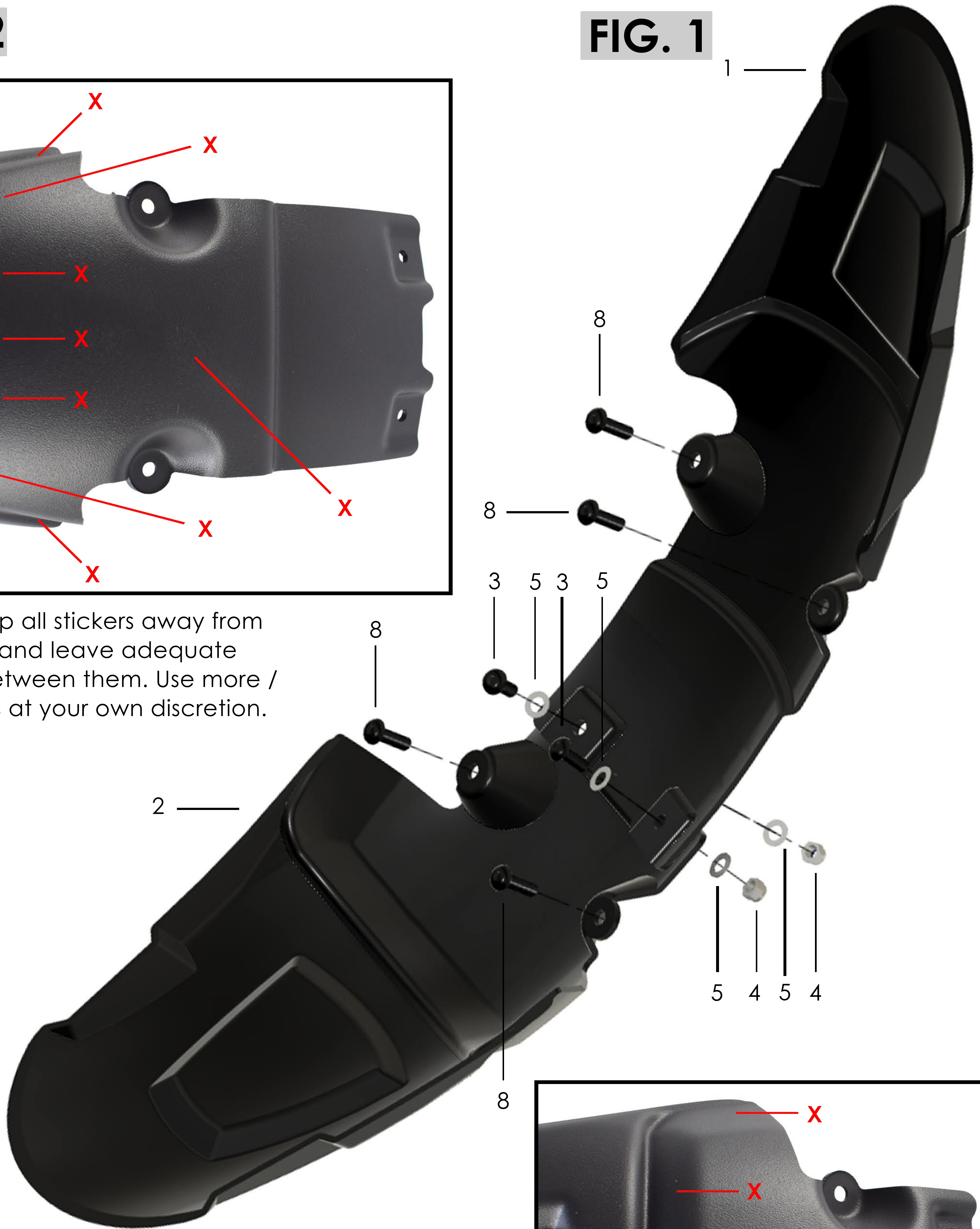

FIG. 3

Any questions?
sales@pyramidmoto.co.uk
 +44 (0)1427 677990
www.pyramidmoto.co.uk



Follow us on social media and feel free to leave us a review!